

ITEM NO.	PART NUMBER	DESCRIPTION	QTY.
1	DR0013R	RIGHT REAR, 70 DEGREE RELIEVED TRACK END (CP TITANIUM)	1
	DR2013R	RIGHT REAR, 70 DEGREE RELIEVED TRACK END (4130 STEEL)	
2	DR0014L	LEFT REAR, 70 DEGREE RELIEVED TRACK END W/ BOTTLE OPENER (CP TITANIUM)	1
	DR2012L	LEFT REAR, 70 DEGREE RELIEVED TRACK END W/ BOTTLE OPENER (4130 STEEL)	

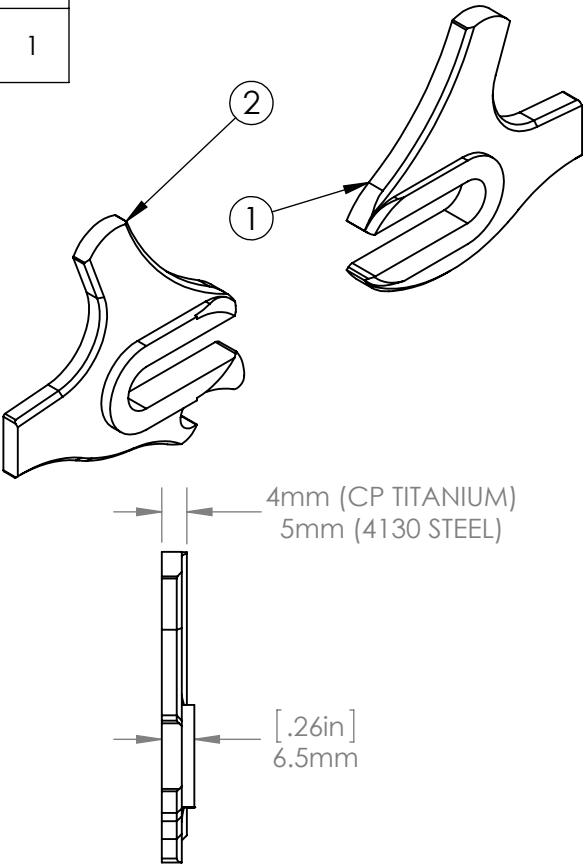
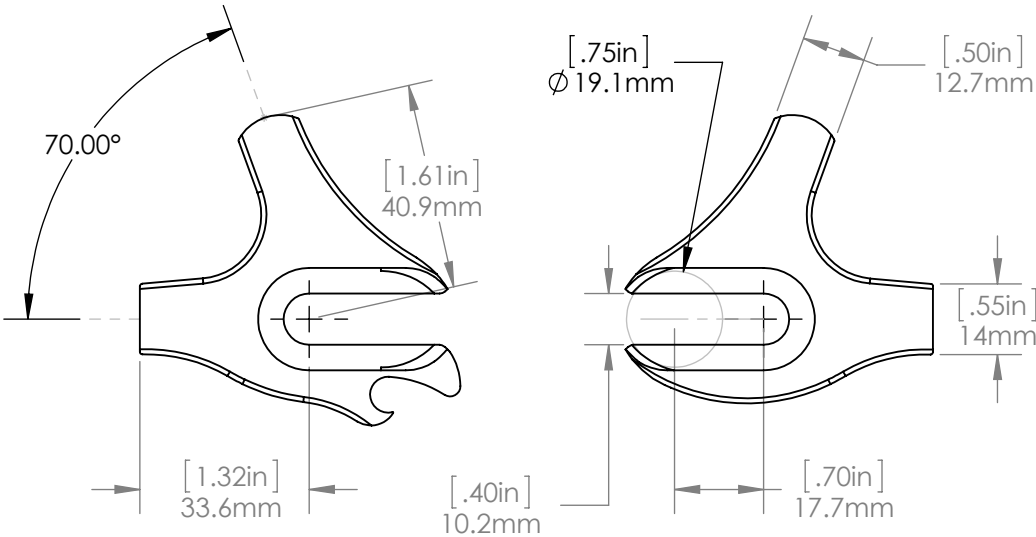

PARAGON MACHINE WORKS

TITLE:
 REAR 70 DEGREE
 RELIEVED TRACK END W/
 BOTTLE OPENER

	NAME	DATE
DRAWN BY:	SWS	11/19/14
CHECKED BY:	MCN	11/19/14
COMMENTS:		

PROPRIETARY AND
CONFIDENTIAL

THE INFORMATION CONTAINED IN THIS
DRAWING IS PROVIDED FOR
FRAMEBUILDERS AND IS THE PROPERTY OF
PARAGON MACHINE WORKS. ANY
REPRODUCTION IN PART OR AS A WHOLE
WITHOUT THE WRITTEN PERMISSION OF
PARAGON MACHINE WORKS IS PROHIBITED.

SIZE	DWG. NO.	REV
A	DR0014	A1